SOCIAL DESIGN AND URBAN INNOVATION IN MEXICO CITY

POWERED BY



CONFIDENTIAL

CHANGE CONSULTING © 2017 ALL RIGHTS RESERVED

This document contains confidential information that is owned by ChangeCreatividadAlfa® (Change Consulting). The possession, reproduction, transmission and / or dissemination of the material as well as fragments of its content is prohibited and its violation represents a criminal offense. For more information: legal@changemx.com
Guadalajara, México © Copyright 2017

EL RETO / THE CHALLENGE

Azcapotzalco, una delegación de la Ciudad de México, no muy lejos del centro. El entorno se siente extraño, una fusión entre lo tradicional de un barrio pero con los riesgos sociales que se viven en nuestro país: calles vacías, callejones peligrosos y algunas áreas en donde parece que el tiempo no ha pasado. Los vecinos viven en zonas económicas complejas: su nivel cultural es (en lo general) bajo y viven en un espectro de frustración.

Empresas, Fábricas y hasta centros de distribución se han Convertido en los nuevos inquilinos ruidosos e Invasivos Todo está en un entorno que gira sobre la segunda universidad más grande de la CDMX. La pregunta para Change Consulting fue ¿Cómo regresar el orden, la paz y la seguridad a la colonia en un escenario de valor para todos?

Azcapotzalco, a delegation from Mexico City, not far from the center. The environment feels strange, a fusion between the traditional of a neighborhood but with the social risks that are lived in our country: empty streets, dangerous alleys and some areas where it seems that time has not passed.

Neighbors live in complex economic zones: their cultural level is (generally) low and they live in a spectrum of frustration. Companies, Factories and even distribution centers have become the new noisy and invasive neighbors. Everything is in an environment that revolves around the second largest university of the CDMX. The question for Change Consulting was How to bring order, peace and security to the colony in a scenario of value for all?

EL RETO / THE CHALLENGE





SOLUCIÓN / SOLUTION

De todo el universo de problemáticas y oportunidades, se sugiere trabajar en 5 ejes rectores:

Comunicación entre vecinos y comunidad

Inseguridad, entornos que mejoren las condiciones

Recreación, hagamos que la gente salga de sus casas

Economía, ayudemos a la micro economía

Infraestructura, mejores espacios y servicios

Of all the universe of problems and opportunities, It is suggested to work in 5 strategic areas:

Communication between neighbors and community

Insecurity, environments that improve conditions

Recreation, get people out of their homes

Economy, let's help the micro economy

Infrastructure, best spaces and services

SOLUCIÓN / SOLUTION



CONCEPTO / CONCEPT



principal corridor

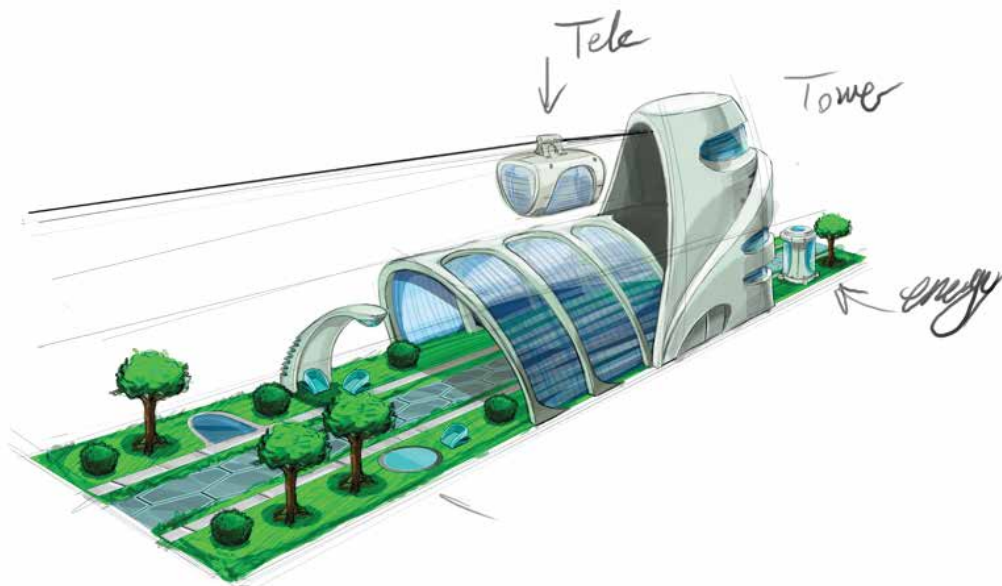

CONCEPTO / CONCEPT



surveillance



surveillance security

CONCEPTO / CONCEPT



access security



surveillance

CONCEPTO / CONCEPT



principal corridor

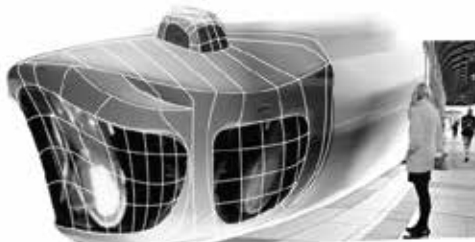
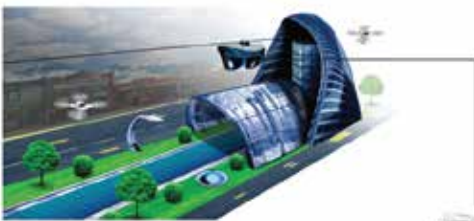

security access

SOCIAL DESIGN AND URBAN INNOVATION IN MEXICO CITY

POWERED BY

